

GT -LDM-16-DSY

1650/1653nm Laser Module

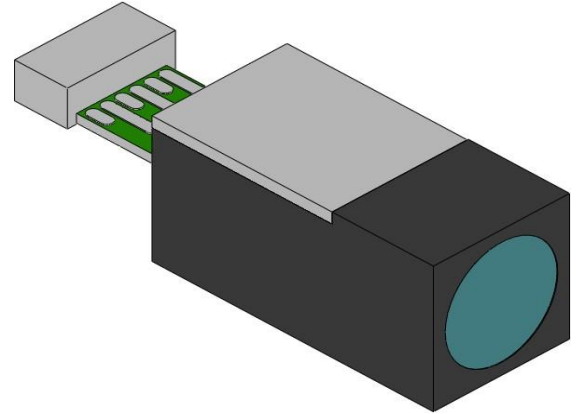

Features 特点

- 1650/1653nm wavelength
- High output power
- Collimated beam output
- Standard 6P terminal
- Supports for precise continuous wavelength tuning by current and temperature
- Designed for high sensitivity methane gas (CH₄) remote detection

1、ABSOLUTE MAXIMUM RATINGS 绝对最大额定值

Parameter 性能参数	Symbol 符号	Ratings 额定值	Unit 单位
Laser Reverse Voltage 激光反向电压	V_F	2	V
Laser Forward Current 激光正向电流	I_F	400	mA
Operating Case temperature 激光工作温度	T_{case}	-20 - 70	°C
Storage Temperature 激光存储温度	T_{STG}	-40 - 100	°C
Thermo-electric Cooler Current TEC 电流	I_{TEC}	1.5	A

2、ELECTRICAL AND OPTICAL CHARACTERISTICS 光电特性 ($T_{SUB}=25^{\circ}C$)

Parameter 性能参数	Symbol 符号	Conditions 测试条件	最小值 Min	典型值 Typ	最大值 Max	单位 Unit
Peak Wavelength 峰值波长	λ (04) λ (05)	CW $I_{OP}=300mA$	1652.7 1649.9	1653.7 1650.9	1654.7 1651.9	nm nm
Threshold Current 阈值电流	I_{th}	CW $T_{SUB}=25^{\circ}C$	-	30	45	mA
Operating Current 工作电流	I_{op}	$P_o=50mW$ $T_{SUB}=25^{\circ}C$	-	300	-	mA
Side Mode Suppression Ratio 边模抑制比	SMSR	CW	35	-	-	dB
Wavelength Temperature Coefficient 波长温度系数	T_{λ}	$T_{SUB}=15\sim 35^{\circ}C$	-	0.095	-	nm/ $^{\circ}C$
Thermistor Resistance 热敏电阻阻值	Ω	$T_{SUB}=25^{\circ}C$	-	10	-	K Ω
Thermo-electric Cooler Current TEC电流	I_{TEC}	$T_{case}=-20\sim 70^{\circ}C$	-	-	1.2	A
Thermo-electric Cooler Voltage TEC电压	V_{TEC}	$T_{case}=-20\sim 70^{\circ}C$	-	-	3	V

3、Collimation lens

- Aspherical lens, AR coated, $R < 1\%$
- Beam divergence $< 1mrad$
- Suited for 100m -150m remote sensing

引脚分配

Pin Assignment

Pin No.	Designations
1	TEC-
2	TEC+
3	Thermistor
4	Thermistor
5	LD+
6	LD-

6P terminal:

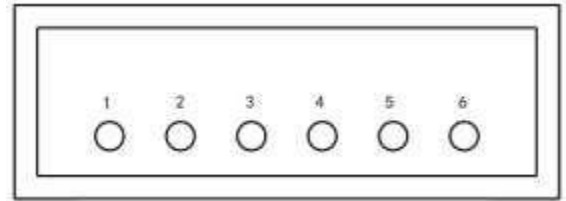

外形尺寸

Outline size (mm)

